



Klipsch[®] GROOVE[®]

PORTABLE *BLUETOOTH*[®] SPEAKER

USER MANUAL

TABLE OF CONTENTS

- 2 - INSIDE
- 3-4 - BUTTONS
- 5-6 - BATTERY CHARGE
- 7-8 - *BLUETOOTH*[®] WIRELESS TECHNOLOGY
- 9 - ENABLE/DISABLE FUNCTION SOUNDS
- 10-11 - AUXILIARY IN
- 12 - ENABLE/DISABLE AUTO OFF FUNCTION
- 13 - FACTORY RESET
- 14 - CARE AND CLEANING

INSIDE

CONTENU • CONTENIDO • INHALT • CONTENUTO • CONTEÚDO • داخل العبوة

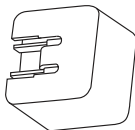
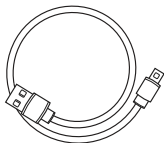
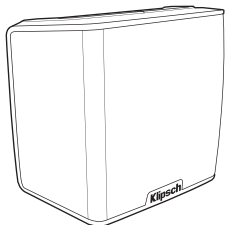

International Adapters Included.
Adaptateurs Internationaux Inclus.
Contiene Adaptadores Internacionales.

Internationale Adapter Im Lieferumfang Enthalten.
Sono Includi Adattatori Internazionali.
Adaptadores Internacionais Incluídos.
مرفق مهايئات دولية.

BUTTONS

CONTENU • CONTENIDO • INHALT • CONTENUTO • CONTEÚDO • الأزرار

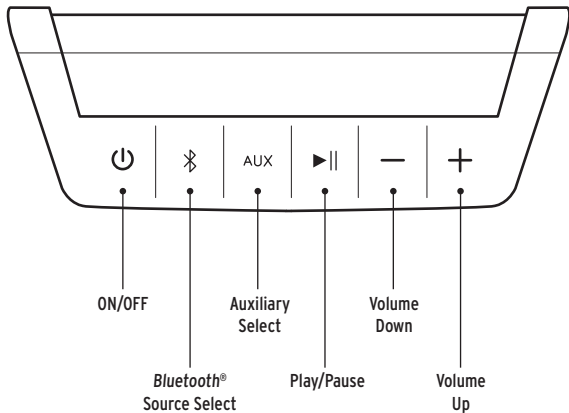

<p>ON/OFF Sous tensio / Hors tension Encendido / Apagado Ein / Aus Acceso / Spento Ligar / Desligar تشغيل/إيقاف</p>	<p>Bluetooth® Source Select Sélection de la source Bluetooth® Selección de fuente Bluetooth® Bluetooth® Quellenwahl Selezione segnale Bluetooth® Seleção de fonte Bluetooth® تحديد مصدر Bluetooth®</p>	<p>Auxiliary Select Sélection auxiliaire Selección de auxiliar AUX-Auswahl Selezione ingresso ausiliario Seleção de auxiliar تحديد الإدخال الإضافي</p>
--	---	---

<p>Play/Pause Lecture/pause Reproducción/pausa Wiedergabe/Pause Riproduzione / Pausa Reproduzir/Pausar تشغيل/إيقاف مؤقت</p>	<p>Volume Down Volume bas Bajada de volumen Leiser Riduzione volume Diminuir o volume خفض مستوى الصوت</p>	<p>Volume Up Volume haut Subida de volumen Lauter Aumento volume Aumentar o volume رفع مستوى الصوت</p>
--	--	---

BATTERY CHARGE

CHARGE BATTERIE • CARGA DE LA PILA • AKKULADESTAND • CARICA BATTERIA • CARGA DA BATERIA • شحن البطارية

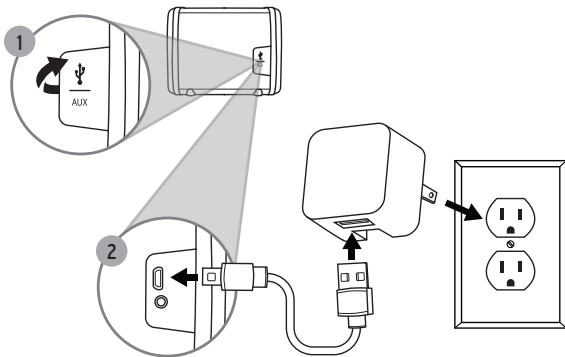

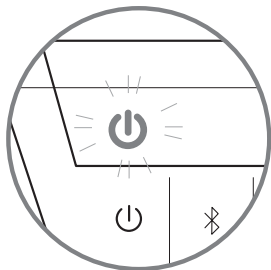

Green =  > 50%

Yellow =  < 50%

Solid Red =  < 10%

Flashing Red =  < 5%

Green	Yellow	Solid Red	Flashing Red
Vert	Jaune	Rouge continu	Clignotement Rouge
Verde	Amarillo	Rojo continuo	Destella Rojo
Grün	Gelb	Dauerhaft Rot	Blinkt Rot
Verde	Giallo	Vermelho a luce fissa	Vermelho lampeggiante
Verde	Amarela	Rosso costante	Rosso intermitente
أخضر	أصفر	أحمر ثابت	أحمر وامض

BLUETOOTH® WIRELESS TECHNOLOGY

TECNOLOGÍA INALÁMBRICA *BLUETOOTH*® • CONFIGURACIÓN DE TECNOLOGIA WIRELESS *BLUETOOTH*® •
DRAHTLOSE *BLUETOOTH*®-TECHNOLOGIE-SETUP • CONFIGURAZIONE TECNOLOGIA WIRELESS *BLUETOOTH*® •
CONFIGURAÇÃO DE TECNOLOGIA SEM FIO *BLUETOOTH*® • تكنولوجيا *BLUETOOTH*® اللاسلكية

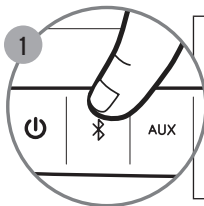

Hold 3 Seconds

Appuyer pendant 3 secondes

Mantenga oprimido durante 3 segundos

3 Sekunden gedrückt halten

Tenere premuto per 3 secondi

Manter pressionado por 3 segundos

اضغط لمدة 3 ثوان

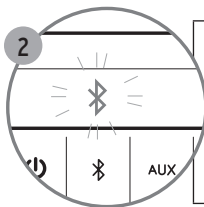

Flashing

Clignotant

Destello

Blinkt

Lampeggiante

Intermittente

وميض

*** Example only. Your device may differ.**

• À titre d'exemple seulement. Votre appareil peut être différent. • Este es solo un ejemplo. Es posible que su dispositivo sea diferente. • Nur als Beispiel. Ihr Gerät kann anders aussehen. • Solo a titolo esemplificativo. Lo specifico dispositivo può essere diverso. • Apenas para exemplo. O dispositivo pode ser diferente. • مثال فقط قد يختلف جهازك.

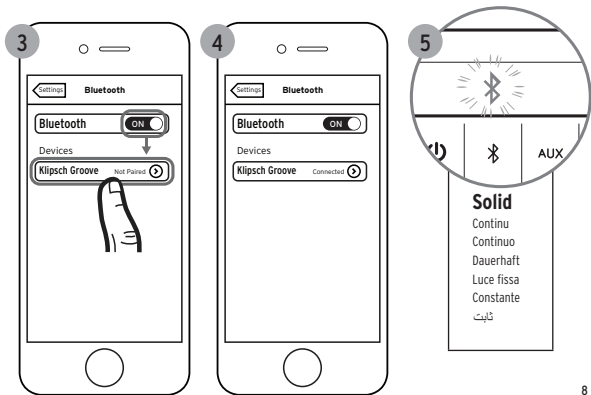

ENABLE/DISABLE FUNCTION SOUNDS

SONS DES FONCTIONS D'ACTIVATION/DE DÉSACTIVATION • HABILITACIÓN/INHABILITACIÓN DE SONIDOS DE FUNCIÓN
• FUNKTIONSGERÄUSCHE AKTIVIEREN/DEAKTIVIEREN • ATTIVAZIONE/DISATTIVAZIONE SUONI DELLE FUNZIONI •
ATIVAR/DESATIVAR SONS DAS FUNÇÕES • تمكين/تعطيل أصوات الوظائف

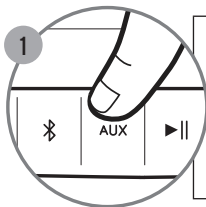

Hold 5 Seconds

Appuyer pendant 5 secondes

Mantenga oprimido durante 5 segundos

5 Sekunden gedrückt halten

Tenere premuto per 5 secondi

Manter pressionado por 5 segundos

اضغط لمدة 5 ثوان

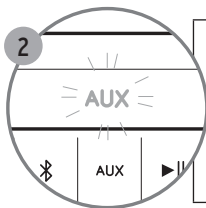

Flashing

Clignotant

Destello

Blinkt

Lampeggiante

Intermittente

وميض

AUX IN

AUX IN • ENTRADA AUX • AUX IN • IN AUX • AUX IN • الإدخال الإضافي

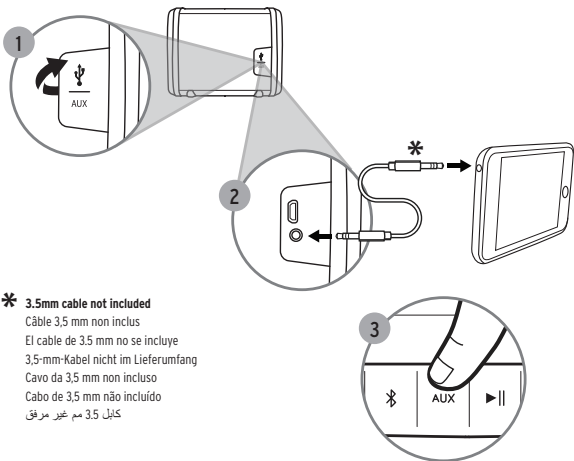

* 3.5mm cable not included

Câble 3,5 mm non inclus

El cable de 3,5 mm no se incluye

3,5-mm-Kabel nicht im Lieferumfang

Cavo da 3,5 mm non incluso

Cabo de 3,5 mm não incluído

كابل 3.5 مم غير مرفق

AUX IN

AUX IN • ENTRADA AUX • AUX IN • IN AUX • AUX IN • الإدخال الإصغاعي

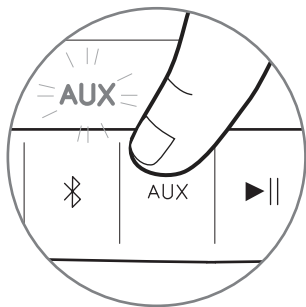

ENABLE/DISABLE AUTO OFF FUNCTION

LA FONCTIONS DE DÉSACTIVATION AUTOMATIQUE D'ACTIVATION/DE DÉSACTIVATION • HABILITACIÓN/INHABILITACIÓN LA FUNCIÓN DE APAGADO AUTOMÁTICO • AUTOMATISCHEN AUS-FUNKTION AKTIVIEREN/DEAKTIVIEREN • ATTIVAZIONE/DISATTIVAZIONE LA FUNZIONI DI SPEGNIMENTO AUTOMATICO • ATIVAR/DESATIVAR A FUNÇÃO DE DESLIGAMENTO AUTOMÁTICO • تمكين/تعطيل التلقائي وظيفة

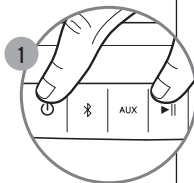

Hold 5 Seconds

Appuyer pendant 5 secondes
Mantenga oprimido durante 5 segundos
5 Sekunden gedrückt halten
Tenere premuto per 5 secondi
Manter pressionado por 5 segundos
اضغط لمدة 5 ثوان

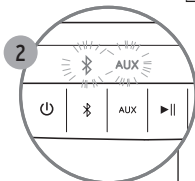
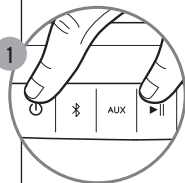

ENABLED
D'ACTIVATION
HABILITACION
AKTIVIEREN
ATTIVAZIONE
ATIVAR
تمكين

Solid

Continu
Continuo
Dauerhaft
Luce fissa
Constante
ثابت

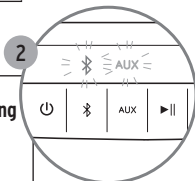

Flashing

Clignotant
Destello
Blink
Lampeggiante
Intermitente
وميض

DISABLED
DESACTIVATION
INHABILITACION
DEAKTIVIEREN
DISATTIVAZIONE
DESATIVAR
تعطيل

FACTORY RESET

RÉINITIALISATION • RESTABLECIMIENTO DE FÁBRICA • RÜCKSETZUNG AUF WERKSEINSTELLUNG •
RIPRISTINO IMPOSTAZIONI DI FABBRICA • RESTABELECIMENTO DAS CONFIGURAÇÕES DE FÁBRICA • إعادة ضبط المصنع

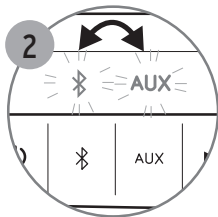
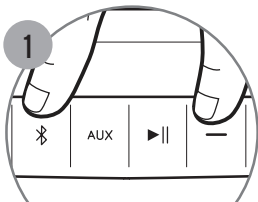

Hold 5 Seconds

Appuyer pendant 5 secondes

Mantenga oprimido durante 5 segundos

5 Sekunden gedrückt halten

Tenere premuto per 5 secondi

Manter pressionado por 5 segundos

اضغط لمدة 5 ثوان

NOTE: Clears *Bluetooth*[®] pairing history

Remarque : Efface l'historique d'appariement *Bluetooth*[®]

NOTA: Borra el historial de sincronización *Bluetooth*[®]

Hinweis: Löscht *Bluetooth*[®]-Kopplungsdaten

Nota: cancella la cronologia delle associazioni *Bluetooth*[®]

Observação: Limpa o histórico de emparelhamento *Bluetooth*[®]

13

ملاحظة: يمسح تاريخ الاقتران بتقنية *Bluetooth*[®]

CARE AND CLEANING

ENTRETIEN ET NETTOYAGE • CUIDADO Y LIMPIEZA • PFLEGE UND REINIGUNG • CURA E PULIZIA •
CUIDADOS E LIMPEZA • العناية والتنظيف



This product is IPX 4 rated splash resistant.

Ce produit est protégé contre les éclaboussures
selon la norme IPX 4

Este producto es clase IPX4, resistente a las salpicaduras

Dieses Produkt ist spritzwassergeschützt gemäß
Norm IPX 4

Questo prodotto presenta grado di protezione IPX4 -
resistente agli spruzzi d'acqua

Este produto tem classificação IPX 4 para resistência
a respingos

هذا المنتج مقاوم للرشاذا بتصنيف IPX 4

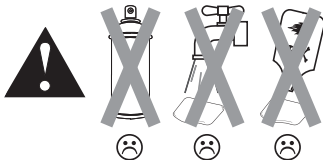

Klipsch®

KEEPERS OF THE SOUND™

3502 WOODVIEW TRACE, INDIANAPOLIS, IN, USA

KLIPSCH.COM



©2018, Klipsch Group, Inc. Klipsch Group, Inc. is a wholly-owned subsidiary of Vox International Corporation. Klipsch and Keepers of the Sound are trademarks of Klipsch Group, Inc., registered in the United States and other countries. The *Bluetooth*® word mark is a registered trademark owned by Bluetooth SIG, Inc. and any use of such mark by Klipsch Group, Inc. is under license.

V01 - MK2 - 181217